

Style 441 Stainless Steel Vic-Flange Adapter

PRODUCT DESCRIPTION



The Style 441 Stainless Steel Vic-Flange adapter is designed for directly incorporating stainless flanged components with ANSI Class 150 bolt hole patterns into a grooved stainless steel pipe system. Available with a variety of gasket materials to meet most service applications, Style 441 is available in 2 through 6-inch/50 – 150 mm sizes. The Style 441 flange adapter has integral end tabs that facilitate assembly. Constructed from corrosion resistant Grade CF8M (316 equivalent) stainless steel, the flange adapter is ideal for externally corrosive environments.

DIMENSIONS

Style 441

Sizes 2 - 6"/50 - 150 mm

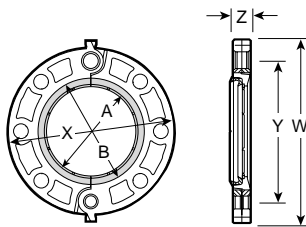

Note: Gray area of mating face must be free from gouges, undulations or deformities of any type for effective sealing.

Nominal Size In./mm	Actual Outside Dia. In./mm	Max. Work Pres. PSI*# kPa	Max. End Load Lbs.* N	No. Bolts † Req'd.	Bolt Size † Inches	Sealing Surface Inches/mm		Dimensions Inches/millimeters				Aprx. Wgt. Each Lbs. kg
						"A" Max.	"B" Min.	W	X	Y	Z	
2 50	2.375 60.3	275 1896	1220 5429	4	5/8 X 2 3/4	2.40 61	3.40 86	6.84 174	6.00 152	4.75 121	0.82 21	3.0 1.4
2 1/2 65	2.875 73.0	275 1896	1785 7943	4	5/8 X 3	2.90 74	3.9.0 99	7.72 196	7.00 178	5.50 140	0.88 22	4.3 2.0
3 80	3.500 88.9	275 1896	2645 11770	4	5/8 X 3	3.50 89	4.50 114	8.22 209	7.50 191	6.00 152	0.94 24	4.8 2.2
4 100	4.500 114.3	275 1896	4375 19469	8	5/8 X 3	4.50 114	5.50 140	9.72 247	9.00 229	7.50 191	0.94 24	6.9 3.1
6 150	6.625 168.3	200 1379	6895 30683	8	3/4 X 3 1/2	6.60 168	7.80 198	11.78 299	11.00 279	9.50 241	1.00 25	9.5 4.3

*Refer to notes on Page 2.

†Total bolts required to be supplied by installer. Bolt sizes for conventional flange-to-flange connection.

#Based on Schedule 10S pipe roll grooved with Victaulic "Rx" stainless steel rolls.

WORKING PRESSURES

Nominal Size In./mm	Actual Outside Dia. In./mm	Schedule 5S	Schedule 10S	Schedule 40S
2 50	2.375 60.3	200 1379	275 1896	275 1896
2 1/2 65	2.875 73.0	200 1379	275 1896	275 1896
3 80	3.500 88.9	200 1379	275 1896	275 1896
4 100	4.500 114.3	200 1379	275 1896	275 1896
6 150	6.625 168.3	125 862	200 1379	275 1896

VIC-FLANGE ADAPTER NOTES

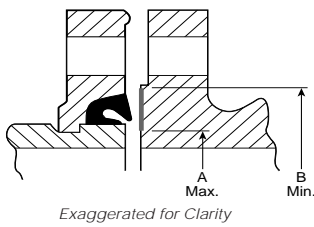

1 Working Pressure and End Load are total, from all internal and external loads, based on Schedule 10S stainless steel pipe, roll grooved with Victaulic "Rx" stainless steel rolls in accordance with Victaulic specifications. Contact Victaulic for performance on other pipe.

WARNING: FOR ONE TIME FIELD TEST ONLY, the maximum Joint Working Pressure may be increased to 1½ times the figures shown.

2 The Style 441 does not rigidly attach to the grooved pipe. Some axial, angular and rotation flexibility of the pipe is to be expected.

3 The Style 441 is designed for use with Class 150 raised-face flanges, in accordance with ANSI B16.5. When a Style 441 is used with a flat-faced flange, the raised projections on the outside edge and around the mating holes of the flange adapter must be ground flush to the body. Refer to the Style 441 Installation Instructions.

4 The Style 441 cannot be used, unless it mounts flush to the mating flange; therefore, flange washers, or anything else that prevents flush mounting, cannot be used.

5 The Style 441 must not be used as anchor points for tie rods across non-restrained joints.

6 The Style 441 must not be used against rubber coated surfaces or with wafer or lug-type valves, or when the flange adapter does not mount flush with the mating flange.

7 Because of the outside flange dimension, the Style 441 must not be used 90° to one another on a standard fitting.

8 Area A-B noted in the accompanying drawing must be free from gouges, undulations or deformities of any type for effective sealing.

9 Style 441 Flange adapter gaskets must always be assembled with the color coded lip on the pipe and the other lip facing the mating flange. The markings on the outside of the gasket must face the Style 441 flange adapter.

10 WARNING: Depressurize and drain the piping system before attempting to install, remove, or adjust any Victaulic piping products.

MATERIAL SPECIFICATIONS

Body: CF8M stainless steel conforming to ASTM A-351, A-743 and A-744.

Gasket:

*Services listed are General Service Recommendations only. It should be noted that there are services for which these gaskets are not recommended. Reference should always be made to the latest Victaulic Gasket Selection Guide (05.01) for specific gasket service recommendations and for a listing of services which are not recommended.

• **Grade "E" EPDM**

EPDM (Green color code). Temperature range -30°F to +230°F/-34°C to +110°C. Recommended for cold and hot water service within the specified temperature range plus a variety of dilute acids, oil-free air and many chemical services. UL Classified to ANSI/NSF 61 for cold +86°F/+30°C and hot +180°F/+82°C potable water service. NOT RECOMMENDED FOR PETROLEUM SERVICES.

• **Grade "T" nitrile**

Nitrile (Orange color code). Temperature range -20°F to +180°F/-29°C to +82°C. Recommended for petroleum products, air with oil vapors, vegetable and mineral oils within the specified temperature range. Not recommended for hot water services over +150°F/+66°C or for hot dry air over +140°F/+60°C.