

# FireLock® Outlet-T

STYLE 922



**WARNING**

- Read and understand all instructions before attempting to install any Victaulic piping products.
- Wear safety glasses, hardhat, and foot protection.

Failure to follow these instructions could result in serious personal injury and/or property damage.

**WARNING**

- Depressurize and drain the piping system before attempting to install, remove, or adjust any Victaulic piping products.

Failure to follow this instruction could result in serious personal injury and/or property damage.

The Style 922 FireLock Outlet-T is designed for direct connection of sprinkler heads, drop nipples, sprigs, drains, gauges, and other outlet products. **The Style 922 FireLock Outlet-T is UL Listed and FM Approved up to 300 psi/2068 kPa and VdS Approved up to 16 Bar/232 psi at ambient temperatures that are typical for fire protection systems.**

## PRODUCT DATA

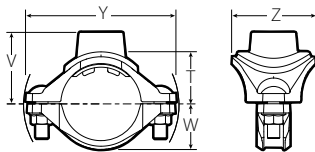

Nominal Size inches/mm	Hole Diameter	Dimensions – inches/millimeters						Approx. Wgt. Each
		Run x Branch FPT†	+0.06/+1.5 -0.00/-0.0	T*	V	W	Y	
1 ¼ 32	x ½ 15	1 ⅜ 30.2	1.30 33.0	1.83 46.5	1.10 27.9	3.87 98.3	2.56 65.0	1.0 0.45
		1 ⅝ 30.2	1.28 32.5	1.83 46.5	1.10 27.9	3.87 98.3	2.56 65.0	1.1 0.50
		1 30.2	1.52 38.6	2.18 55.4	1.10 27.9	3.87 98.3	2.56 65.0	1.2 0.54
		1 ⅞ 30.2	1.42 36.1	1.95 49.5	1.22 31.0	4.08 103.6	2.56 65.0	1.2 0.54
1 ½ 40	x ¾ 20	1 ⅝ 30.2	1.40 35.6	1.95 49.5	1.22 31.0	4.08 103.6	2.56 65.0	1.2 0.54
		1 30.2	1.64 41.7	2.30 58.4	1.22 31.0	4.08 103.6	2.56 65.0	1.3 0.59
		1 ⅞ 30.2	1.66 42.2	2.19 55.6	1.46 37.1	4.60 116.8	2.56 65.0	1.3 0.59
		2 30.2	1.64 41.7	2.19 55.6	1.46 37.1	4.60 116.8	2.56 65.0	1.4 0.64
2 50	x 1 25	1 ⅞ 30.2	1.88 47.8	2.54 64.5	1.46 37.1	4.60 116.8	2.56 65.0	1.5 0.68
		2 ½ 30.2	1.91 48.5	2.44 62.0	1.71 43.4	5.40 137.2	2.56 65.0	1.6 0.73
		1 ⅞ 30.2	1.89 48.0	2.44 62.0	1.71 43.4	5.40 137.2	2.56 65.0	1.6 0.73
		2 30.2	2.13 54.1	2.79 70.9	1.71 43.4	5.40 137.2	2.56 65.0	1.6 0.73
2 ½ 65	x 1 ¼ 30	1 ⅞ 30.2	1.91 48.5	2.44 62.0	1.71 43.4	5.40 137.2	2.56 65.0	1.6 0.73
		2 30.2	1.89 48.0	2.44 62.0	1.71 43.4	5.40 137.2	2.56 65.0	1.6 0.73
		2 ½ 30.2	2.13 54.1	2.79 70.9	1.71 43.4	5.40 137.2	2.56 65.0	1.6 0.73
		3 30.2	2.13 54.1	2.79 70.9	1.71 43.4	5.40 137.2	2.56 65.0	1.7 0.80
76.1 mm	x ¾ 20	1 ⅞ 30.2	1.91 48.5	2.44 62.0	1.71 43.4	5.50 139.7	2.56 65.0	1.6 0.73
		2 30.2	1.89 48.0	2.44 62.0	1.71 43.4	5.50 139.7	2.56 65.0	1.6 0.73
		2 ½ 30.2	2.13 54.1	2.79 70.9	1.71 43.4	5.50 139.7	2.56 65.0	1.6 0.73
		3 30.2	2.13 54.1	2.79 70.9	1.71 43.4	5.50 139.7	2.56 65.0	1.7 0.80

† Victaulic female threaded products are designed to accommodate standard NPT or BSPT (Optional) male pipe threads only. Use of male threaded products with special features, such as probes, dry pendent sprinkler heads, etc., should be verified as suitable for use with this Victaulic product. Failure to verify suitability in advance may result in assembly problems or leakage.

\* Center of run to engaged pipe end for NPT threads (dimensions are approximate).

# FireLock® Outlet-T

STYLE 922

## PIPE PREPARATION

### NOTICE

- Victaulic hole cutting tools are recommended for proper hole preparation.

1. Cut a hole on the centerline of the pipe. Refer to table on page 1 for hole requirements.

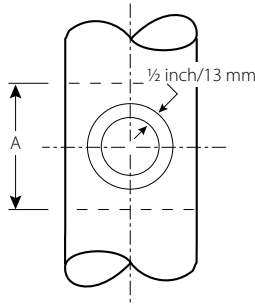

Exaggerated for clarity

2. Ensure that a 1/2-inch/13-mm area around the hole is clean, smooth, and free from indentations and/or projections that could affect gasket sealing (refer to the sketch above). Remove any burrs and sharp or rough edges from the hole that might affect assembly, proper seating of the locating collar, flow from the outlet, or gasket seating.

## INSTALLATION



1. Install the gasket into the gasket pocket, as shown above. Press the gasket along the full circumference to ensure that it fully seats in the gasket pocket. **DO NOT LUBRICATE THE GASKET.**

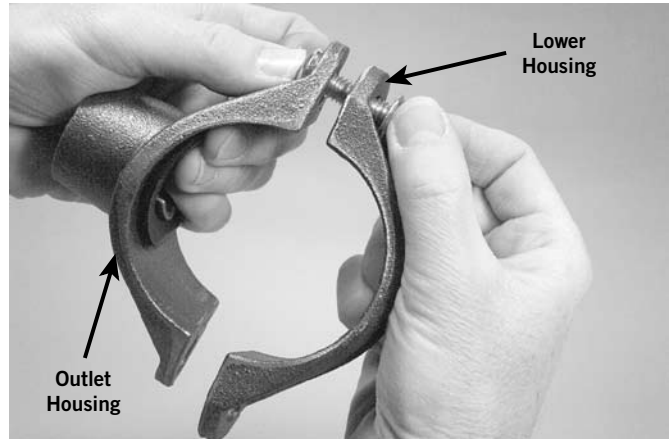

2. Insert a bolt into the outlet housing and lower housing, and thread a nut loosely onto the bolt (nut should be flush with end of bolt) to allow for the "swing-over" feature, as shown above.



3. Install the outlet housing onto the pipe by centering the locating collar in the hole. To check for proper engagement, slide the outlet housing back and forth while pushing down. A properly positioned outlet housing can be moved only a small amount in any direction.
- 3a. Rotate the lower housing around the pipe, while holding the outlet housing in place to make sure the locating collar remains seated properly in the hole.



4. Insert the other track bolt into the outlet housing and lower housing. Install the nut finger-tight.

## FireLock® Outlet-T

STYLE 922

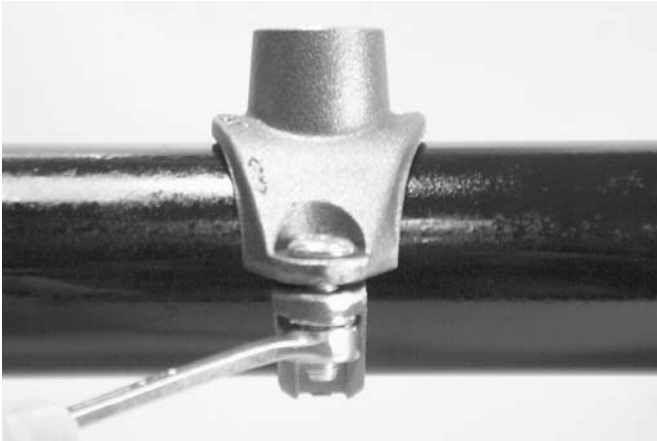

5. Tighten the nuts evenly to an approximate torque value of 20ft-lbs/27.1-N•m to ensure proper gasket compression. **NOTE:** To avoid over-tightening the nuts, use a wrench with a maximum length of 8 inches/200mm. **DO NOT** over-tighten the nuts.

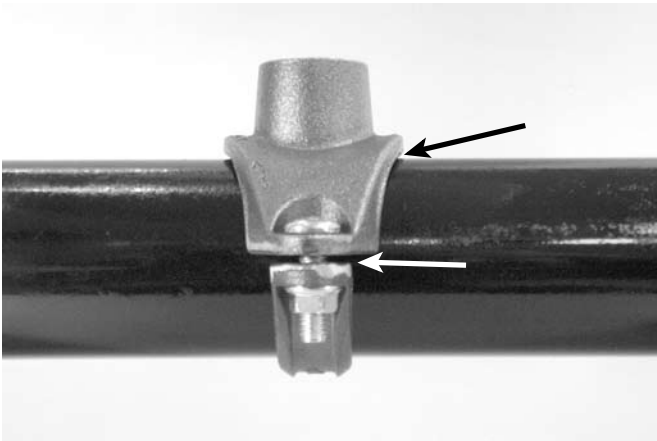

The outlet housing, near the gasket, should not make metal-to-metal contact with the pipe. In addition, a small gap is expected between the outlet housing and the lower housing, as shown above.

### **WARNING**

- **DO NOT over-tighten the nuts. Over-tightening the nuts can over-compress the gasket and distort the outlet housing and lower housing. Over-tightening does not enhance product performance.**

**Failure to follow this instruction could cause product failure, resulting in serious personal injury and/or property damage.**

# FireLock® Outlet-T

STYLE 922

---



---

For complete contact information, visit [www.victaulic.com](http://www.victaulic.com)

I-922 3393 REV C Z100922000 UPDATED 3/2004

VICTAULIC IS A REGISTERED TRADEMARK OF VICTAULIC COMPANY. © 2004 VICTAULIC COMPANY. ALL RIGHTS RESERVED. PRINTED IN THE USA.

